

M27 Junction 10 Improvement

Statutory Instrument Consultation Document

**Proposed amendments to the M27 Motorway
(Junctions 4 to 11) (Variable Speed Limits)
Regulations 2021**

6 November 2023

Summary of the consultation

Topic of this consultation	National Highways Limited's proposed Statutory Instrument which will amend the M27 Motorway (Junctions 4 to 11) (Variable Speed Limits) Regulations 2021 (the 2021 Regulations).
Scope of this consultation	<p>This consultation provides the opportunity for you to share your feedback on the proposed amendments to the 2021 Regulations. The amendments are required due to the proposed improvements to Junction 10 of the M27 motorway in Hampshire.</p> <p>We are keen to have your comments on the proposal set out in this document. We specifically would like to hear how the proposal could affect you, your organisation or those you represent.</p>
Geographical scope	The improvements relate to Junction 10 of the M27 motorway in Hampshire including the additional slip roads that will be constructed.
Why are changes being made to Junction 10	<p>The improvements to Junction 10 of the M27 motorway are required to facilitate access to 6,000 new homes planned at Welborne Garden Village and the new Welborne Science & Technology Park (the M27 Junction 10 improvements scheme, referred to as 'the Scheme').</p> <p>Planning Permission for the Scheme was granted in September 2021 as part of the wider Welborne development by Fareham Borough Council (FBC) as the determining Planning Authority. The planning permission included the detailed permission for the Scheme alongside outline permission for the wider Welborne development.</p> <p>Work on M27 Junction 10 is planned to start in 2024. The Scheme requires amendments to be made to the 2021 Regulations. These amendments are explained in this document and a new Statutory Instrument is needed to amend the 2021 Regulations.</p>

General Information

To	The consultation is directed towards any affected stakeholder group or individuals.
Body/bodies responsible for the consultation	National Highways Limited.
Duration	The consultation will last for a period of 4 weeks, commencing on 6 November 2023. The consultation will close on 4 December 2023 . Please ensure that your response arrives before the closing date.

How to respond	Please respond to the consultation through our online survey. A link to the survey can be found here: CitizenSpace
Additional ways to become involved	<p>Alternatively, you can complete the consultation response form at Appendix B and email it to:</p> <p>vmsl-m27j10@nationalhighways.co.uk</p> <p>or post it to:</p> <p>Project Manager M27 Junction 10 Project National Highways Limited Regional Investment Programme (South East) Bridge House 1 Walnut Tree Close Guildford Surrey GU1 4LZ</p>
After the consultation	<p>All responses received within the consultation period will be reviewed and considered by the project team.</p> <p>Following the consultation, a summary report will be published on the National Highways website to provide an analysis of the responses.</p>

Contents

1. How we are conducting the consultation

- 1.1. What is this consultation about?
- 1.2. How to respond to this consultation
- 1.3. How we will act on your responses
- 1.4. Confidentiality of Information
- 1.5. Further Information
- 1.6. The Government's Consultation Principles

2. Legislative changes

- 2.1. Proposed amendments to the M27 Motorway (Junctions 4 to 11) (Variable Speed Limits) Regulations 2021

3. General information – M27 J10 Improvement Scheme

- 3.1. Background
- 3.2. Key Features
- 3.3. Project Benefits

4. Appendices

Appendix A: Frequently asked questions

Appendix B: Consultation response form

1. How we are conducting the consultation

1.1. What is this consultation about?

This consultation concerns amendments which are required to the 2021 Regulations to make provision for the improvements being made to Junction 10 of the M27 motorway in Hampshire. Junction 10 needs to be improved to facilitate access to 6,000 new homes and a new science and technology park which are planned to be built at Welborne Garden Village.

The three new slip roads at junction 10 will be subject to the same variable speed limits as are currently applied to the main carriageway of the M27, in order to help manage the flow of traffic onto the M27 motorway. It is this change that requires an amendment to the 2021 Regulations and is the subject of this consultation.

The Regulations introduced in 2021 applied VMSL to specified sections of the M27 motorway between Junctions 4 and 11. Where VMSL are in operation, a vehicle may not be driven at a speed above the maximum indicated by each speed limit sign passed by a vehicle until it passes a sign indicating that the national speed limit applies, or the vehicle leaves the road covered by the regulation.

To manage the flow of traffic joining a VMSL controlled carriageway, VMSL are required on adjoining slip roads. The proposed Statutory Instrument will amend the 2021 Regulations to enable VMSL on the new slip roads at Junction 10.

This consultation solely concerns the proposed amendments the 2021 Regulations which will enable VMSL to be implemented on the new slip-roads onto the M27.

1.2. How to respond to this consultation

This consultation will run from 6 November 2023 to 4 December 2023.

If you are responding on behalf of an organisation, it would greatly assist our analysis if you make this clear including details such as: the nature of the organisation, the ways in which your views were developed or gathered, and where relevant how many individuals' views were included in the response.

You can respond to the consultation by:

- Completing our online survey. A link to the survey can be found on the scheme webpage at: [Project website](#).
- Completing the consultation response form located at **Appendix B** and returning it to us by email or by post to the addresses below.

Email: : vmsl-m27j10@nationalhighways.co.uk

Post: Project Manager
M27 J10 Improvement Project
National Highways Limited
Regional Investment Programme (South East)
Bridge House
1 Walnut Tree Close
Guildford
Surrey
GU1 4LZ

1.3. How we will act on your responses

All responses received within the consultation period will be assessed and considered. Following the consultation period, a summary consultation report will be made available on National Highways' website. The report will provide an analysis of responses received and provide National Highways' feedback on these.

1.4. Confidentiality of information

Information provided in response to this consultation, including personal information, may be published or disclosed in accordance with the access to information regimes. These are primarily the Freedom of Information Act 2000 (FOIA), the Data Protection Act 2018 (DPA), the UK General Data Protection Regulation (UK GDPR) and the Environmental Information Regulations 2004.

If you would like the information that you provide to be treated as confidential, it would be helpful if you could explain to us why you regard the information as confidential. Any information not published, including personal information, may still be subject to disclosure in accordance with FOIA. If we receive a request for disclosure of such unpublished information, we will take full account of your explanation, but we cannot give an assurance that confidentiality can be maintained in all circumstances. We will not take a standard confidentiality statement included in an email message as a specific request for non-disclosure.

National Highways' will process your personal data in accordance with the DPA and UK GDPR and in the majority of circumstances this will mean that your personal data will not be disclosed to third parties. However, the information you send us may need to be published in a summary of responses to this consultation.

If you'd like more information about how we manage data, or a copy of our privacy notice, please contact DataProtectionAdvice@nationalhighways.co.uk.

1.5. Further information

To receive further information on the scheme you can contact the project team in writing at:

Project Manager
M27 J10 Improvement Project
National Highways Limited
Regional Investment Programme (South East)
Bridge House
1 Walnut Tree Close
Guildford
Surrey
GU1 4LZ

Or by email: vmsl-m27j10@nationalhighways.co.uk

Alternatively, visit National Highways website:

[Project website](#)

1.6. The Government's Consultation Principles

We are conducting this consultation in accordance with the Government's Consultation Principles which can be found on the GOV.UK website:

<https://www.gov.uk/government/publications/consultation-principles-guidance>.

2. Legislative changes

2.1. Proposed amendments to the 2021 Regulations

Subject to the outcome of this consultation, National Highways Limited proposes to make a Statutory Instrument under section 17(2) and (3) of the Road Traffic Regulation Act 1984 (the 1984 Act). Section 17 (2) and (3) of the 1984 Act permit the making of Regulations (by way of a Statutory Instrument) that regulate the manner in which, and the conditions subject to which, motorways may be used by traffic authorised to use such motorways.

The proposed Statutory Instrument will amend the 2021 Regulations, which introduced VMSL on specified sections of the M27 motorway between Junctions 4 and 11.

The amendment will reference the changes being made to Junction 10 as a consequence of the M27 J10 Improvement Scheme which will include the addition of VMSL on the three new slip roads.

These changes are necessary to help manage the flow of traffic onto the M27 at Junction 10.

3. M27 J10 Improvement Scheme

3.1. Background

The existing M27 Junction 10 has restricted access, only allowing traffic to leave the M27 westbound and join the M27 eastbound.

Improvements to the junction are required to facilitate access to the Welborne Garden Village Development.

Welborne Garden Village is located to the north of Fareham and the M27, adjacent to the A32, and near the existing M27 Junction 10.

It is a regionally important development site being promoted by Fareham Borough Council through their adopted Welbourne Plan (2015). The development will comprise 6,000 new homes and significant employment space which aims to create more than 5,700 new jobs.

The proposed development includes a district centre, supporting neighbourhood centres, a new secondary school and three new primary schools, all planned to create a new community with its own sense of identity.

3.2. Key Features

The proposed improvements to M27 Junction 10 will include the provision of the following key elements:

- New Eastbound off-slip - diverging from the motorway just east of Funtley Road bridge heading east towards the development site and to a point just north of the proposed new underpass terminating at a new traffic signal-controlled junction. The new eastbound off slip is a single lane diverge / two lane slip road, upon which a new emergency area will be provided.
- New Westbound on-slip - commencing south of the M27, at a point diverging from the roundabout south of the underpass to a merge with the M27 just east of the Funtley Road bridge. The new westbound on-slip will be a single lane slip road and will merge onto the M27.
- Improved Westbound off-slip - an alteration to the existing westbound off-slip which retains the existing slip road diverge just west of the existing A32 underpass, involving the removal of the existing 270-degree loop and replacement with a slip road south off the M27. The new slip road will connect the proposed new tear drop roundabout at the southern end of the new underpass via a new set of traffic signals allowing for pedestrian / cycle crossing movements; The westbound off-slip is a single lane diverge from the M27 mainline widening to two lanes at the traffic signals.
- New underpass link road - a new 23.1m wide underpass underneath the M27 located to the west of the existing junction with the A32 and approximately 150m east of the existing Kneller Court Way access underpass. The underpass will connect with the eastbound off-slip and west-bound on and off slips, catering for north and south traffic movements via two-lanes north-bound and two lanes south-bound. A pedestrian cycleway would be provided alongside the two southbound lanes. A tear-drop roundabout will be provided at the southern end of the underpass and signalised

junction at the northern intersection with eastbound off-slip. The link road will further continue north to connect with a proposed Welborne roundabout.

- New Welborne Approach Link Road – a new dual carriageway link road will head north from the proposed underpass and will continue for approximately 350m to connect with a proposed new 67m ICD roundabout heading into the development site. There will be a 3.0m wide shared use provision for a pedestrian / cycleway along the eastern side.
- New Broadway dual-carriageway link road - a new dual carriageway east-west link road running through the development site north of and parallel with the M27 connecting the new roundabout mentioned above to a new roundabout on the A32 to the east and a new roundabout serving the proposed employment land to the south and District centre to the north. Two pedestrian / cycle 'Toucan' crossing points will be provided along the east-west link and there will be provision for a LTN120 compliant shared use pedestrian / cycleway along both sides.
- New Welborne Approach Roundabout – a new four arm roundabout connecting the Welborne development.
- New Broadway Roundabout – a three arm roundabout at the eastern end of Broadway link road with A32 Wickham Road, Connection to Pook Lane is closed.

To help integrate the development to the wider area a dedicated Bus Rapid Transport (BRT) link and active travel facilities for walking, cycling or using a mobility aid will be provided alongside the new link roads (excluding the slip roads).

This includes crossing points and a link through the underpass under the M27 to connect to the path through Fareham Common that will link active travel users to key facilities in Fareham such as the rail station, schools and the town centre.

Local residents will also benefit from reduced congestion on local roads, improved safety and improved journey times.

The upgraded junction will also help to ensure that the development site will be well connected to the wider south coast strategic transport network to help attract business and investment into the area.

A map showing the proposed Variable Speed Limit extents is at Figure 1 below:

Figure 1.
M27 J10 Improvement - Proposed new Variable Speed Limit extents

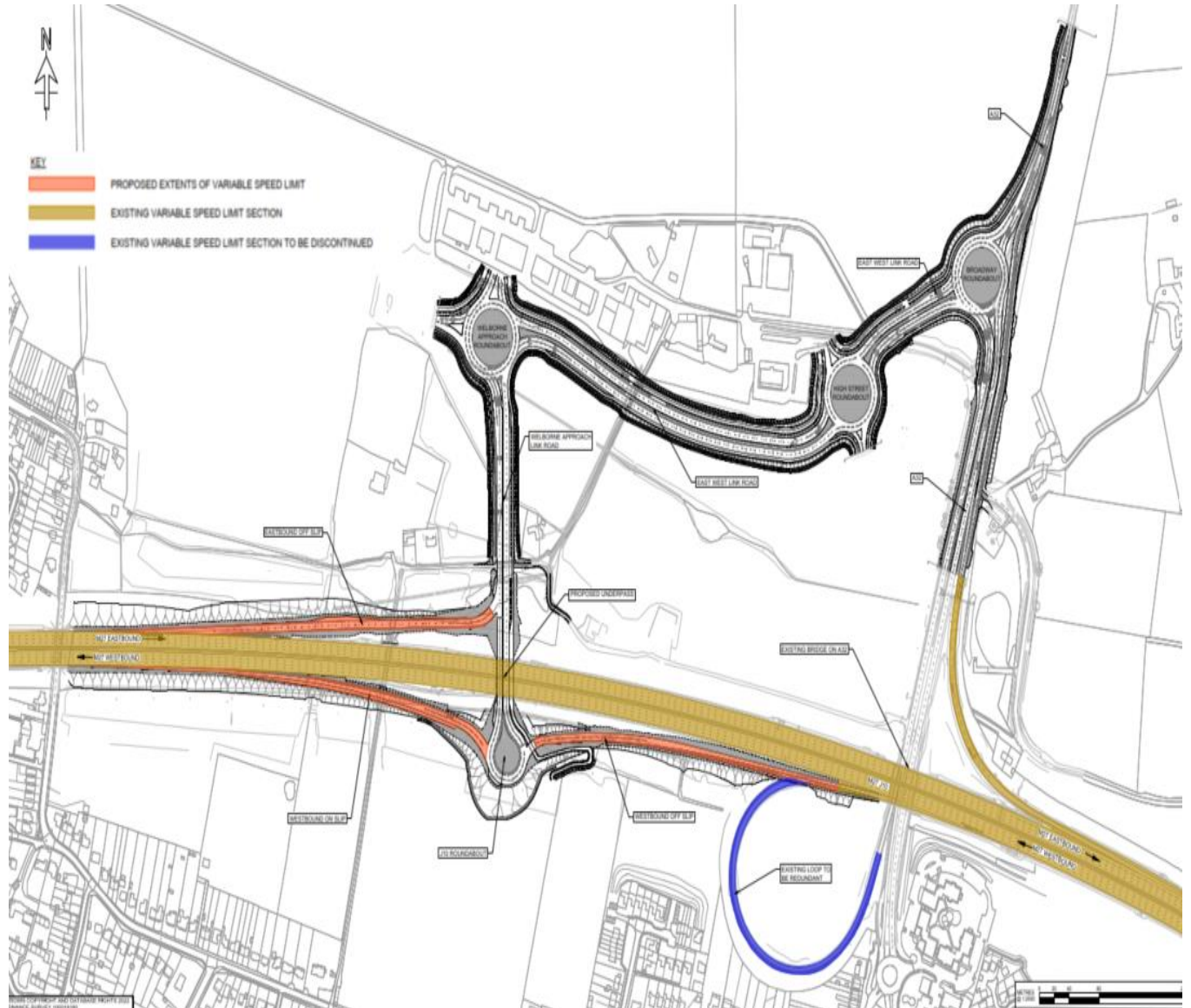

3.3. Project Benefits

M27 Junction 10 Improvement scheme objectives

The scheme objectives are as follows:

- To directly facilitate the development of 6,000 new homes in the regionally significant Welborne Garden Village over the next 25 years;
- To support commercial development and future jobs at Welborne Garden Village over the next 25 years;
- To improve access to emerging and existing business and commercial centres in order to assist employment retention, economic growth and regeneration in Fareham;
- To improve the operational effectiveness on the M27 between Junctions 9 and 11, and reduce peak hour congestion at M27 Junction 11 due to U-turning traffic which has to detour given the current absence of an all movements junction;
- To improve safety on slip roads to provide greater compatibility with current standards (which is particularly important based upon the predicted increased traffic levels at the junction) and to help minimise annual collision frequency and severity ratio on the slip roads;
- To reduce congestion levels and journey time delay on the heavily congested local road network through improved access to the Strategic Road Network (SRN);
- To provide delivery of a junction that facilitates improved bus connectivity to the development;
- To provide safe queueing at the junction and its approaches, and minimise delays through the junction;
- To support and improve existing cycling, walking and other vulnerable user group connections across the M27 in the vicinity of the junction;
- To minimise the impact of traffic on air quality and noise pollution

Appendices

Appendix A – Frequently asked questions

Appendix B – Consultation response form

Appendix A: Frequently asked questions

Q. What is happening?

- A. Hampshire County Council has been awarded a Housing Investment Grant by Homes England to contribute towards the upgrade of Junction 10 of the M27 motorway to facilitate access to 6,000 new homes planned at Welborne Garden Village and the new Welborne Science & Technology Park. As a result, changes are required at Junction 10 of the M27 to increase capacity.

As a Variable Mandatory Speed Limit Statutory Instrument is already in place on the M27 between Junctions 4 and 11, amendment will need to be made to that Statutory Instrument to reflect the changes being made at Junction 10.

National Highways is proposing to address this by making a new Statutory Instrument. The new Instrument will amend the 2021 Regulations (which introduced VMSL on specified sections of the M27 motorway) to also apply VMSL to the new slip roads at Junction 10.

Q. Why is National Highways consulting?

- A. It is a statutory requirement for National Highways to consult on regulations made under s.17 of the 1984 Act.

This consultation provides an opportunity for interested parties, individuals and stakeholders to comment on the proposed changes.

All responses received within the consultation period will be considered. Following the consultation period, a summary report will be published on National Highways website. The summary report will provide an analysis of the responses received and National Highways feedback on these.

Q. What are Variable Mandatory Speed Limits ('VMSL')?

- A. Variable mandatory speed limits control the speed and smooth the flow of traffic, reducing stop-start traffic.

To help manage the flow of traffic joining the M27 at Junction 10, variable speed limits are required on the new adjoining slip roads.

Q. Who can respond to the consultation?

- A. Anyone can respond to the consultation, including individuals, organisations and affected stakeholder groups.

Appendix B: Consultation response form

You can provide your views by completing our online survey. A link to the survey can be found on [CitizenSpace](#).

If you would prefer to submit your response in writing, please complete the below response form and return this to us by post or by email to the addresses below. Please ensure your response reaches us by 23:59 on 4 December 2023.

Project Manager
M27 J10 Improvement Project
National Highways Limited
Regional Investment Programme (South East)
Bridge House
1 Walnut Tree Close
Guildford
Surrey
GU1 4LZ

Or by email: vmsl-m27j10@nationalhighways.co.uk

Part 1: Information about you

Completion of this section is optional but greatly helps with our analysis. Section 1.4 of the Consultation Document explains that we may be obliged to release this information if asked to do so.

Name	
Address	
Postcode	
Email	
Company Name or Organisation (if applicable)	

Please tick one box from the list below that best describes you/your company or organisation.	
<input type="checkbox"/>	Small to Medium Enterprise (up to 50 employees)
<input type="checkbox"/>	Large Company
<input type="checkbox"/>	Representative Organisation
<input type="checkbox"/>	Trade Union
<input type="checkbox"/>	Interest Group

	Local Government
	Central Government
	Police
	Member of the public
	Other (please describe):
If you are responding on behalf of an organisation or interest group, how many members do you have and how did you obtain the views of your members:	
If you would like your response or personal details to be treated confidentially please explain why:	

Part 2: Your Comments

Q1. Do you wish to make any comment regarding the proposal to amend the 2021 Regulations to include the proposed improvements to the M27 at Junction 10? [Section 1.1 above provides the detail]	Yes	
	No	
Please provide any comments below.		
Are there any additional comments you would like to make?	Yes	

	No	