

A585

Windy Harbour to Skippool scheme

Consultation response form



Return by 8 May 2018

A585 Windy Harbour to Skippool scheme

Consultation response form

We want to understand your views on the proposed improvements for the A585 Windy Harbour to Skippool scheme. Please share your views with us by completing this response form or online at <http://roads.highways.gov.uk/projects/a585-windy-harbour-to-skipool/>

If you're returning this to us by post, please follow the instructions on the inside back page of the response form and return it in the post.

Please submit your completed response form to reach us no later than 8 May 2018.

Please provide us with your name and address. If you'd prefer for your comments to be anonymous, please just provide your postcode.

Name:

Address:

.....

..... Postcode:

Email:

Are you responding on behalf of an organisation?

Yes No

If Yes, please name the organisation:

Organisation:

The information you provide will be kept in a secure environment only accessible by Highways England and the specific contractor(s) working with us on this project. Your personal information will not be shared with any other individuals or organisations beyond the provision set out in the Freedom of Information Act 2000 and Environmental Information Regulations 2004. The information you submit will only be used in support of the purpose specified in the survey. Personal details are collected only to ensure entries are not duplicated and in order to contact correspondents if necessary.

A585 Windy Harbour to Skippool – southern bypass

1. What is your interest in the southern bypass based on?

- I am a land / property owner / tenant along the existing A585 route
- I am a land / property owner / tenant along the route of the proposed southern bypass
- I am a land / property owner / tenant near the route of the proposed southern bypass
- I use the affected roads but do not live near the route of the proposed southern bypass

2. What is the main reason you use the existing A585 route?

- Residential Business
- Leisure Education (eg. school runs)
- Commute to work Other (please state)
-
-

3. How do you travel on this route? (tick all that apply)

- Car Bus Bicycle
- Walk HGV / LGV Motorcycle
- Other (please state)
-

4. How often do you travel on this route?

- Daily More than once a week
- Weekly More than once a month
- Monthly Less than once a month
- Don't / won't use the route

5. To what extent do you believe the southern bypass will impact you?

Extent of impact	As a: (tick one box in each column)		
	Traveller along the route	Nearby resident	Owner / occupier directly affected by the scheme
Significant improvement	<input type="checkbox"/>	<input type="checkbox"/>	<input type="checkbox"/>
Slight improvement	<input type="checkbox"/>	<input type="checkbox"/>	<input type="checkbox"/>
Not affected / impacted	<input type="checkbox"/>	<input type="checkbox"/>	<input type="checkbox"/>
Marginally affected / impacted	<input type="checkbox"/>	<input type="checkbox"/>	<input type="checkbox"/>
Affected / impacted	<input type="checkbox"/>	<input type="checkbox"/>	<input type="checkbox"/>
Highly affected / impacted	<input type="checkbox"/>	<input type="checkbox"/>	<input type="checkbox"/>
Don't know / not applicable	<input type="checkbox"/>	<input type="checkbox"/>	<input type="checkbox"/>

6. Do you agree that the southern bypass will achieve the scheme's objectives that are listed on page 4 of the brochure?.

	Strongly agree	Agree	Neither agree nor disagree	Disagree	Strongly disagree	No opinion / Don't know
a. Reduce congestion on the existing A585 through Little Singleton, Shard and Skippool junctions and making people's journeys more reliable?	<input type="checkbox"/>	<input type="checkbox"/>	<input type="checkbox"/>	<input type="checkbox"/>	<input type="checkbox"/>	<input type="checkbox"/>
b. Support employment and residential/commercial development and growth opportunities?	<input type="checkbox"/>	<input type="checkbox"/>	<input type="checkbox"/>	<input type="checkbox"/>	<input type="checkbox"/>	<input type="checkbox"/>
c. Create a more appealing environment for cyclists and pedestrians and support the sense of community along the A585 between Windy Harbour and Skippool?	<input type="checkbox"/>	<input type="checkbox"/>	<input type="checkbox"/>	<input type="checkbox"/>	<input type="checkbox"/>	<input type="checkbox"/>

7. Please explain the reason(s) for your responses to question 6 above.

.....

.....

.....

.....

.....

Details of the proposed bypass

Skippool junction and Skippool Bridge junction (outlined on page 6 of the brochure)

8. Do you agree that the proposed traffic signals at Skippool junction and Skippool Bridge will address the traffic flow issues here?

- Strongly agree Agree Neither agree or disagree
 Disagree Strongly disagree No opinion / don't know

Please explain your answer:

.....

.....

Shard Road link road (outlined on page 4 of the brochure)

9. We've decided not to progress the link road from Skippool Bridge Junction to Shard Road north of Mains Lane (more information is on page 4 of brochure). Do you agree with our decision based on our reasons given?

- Strongly agree Agree Neither agree or disagree
 Disagree Strongly disagree No opinion / don't know

Please explain your answer:
.....
.....

Poulton junction (outlined on page 7 of the brochure)

10. Do you agree that the proposed roundabout at A586 Garstang Road East is the best solution?

- Strongly agree Agree Neither agree or disagree
 Disagree Strongly disagree No opinion / don't know

Please explain your answer:
.....
.....

Bridge over bypass at Lodge Lane (outlined on page 7 of the brochure)

11. Do you believe a wide land bridge over the bypass would be more appropriate than the simple road bridge proposed?

- Strongly agree Agree Neither agree or disagree
 Disagree Strongly disagree No opinion / don't know

Please explain your answer:
.....
.....

12. Regarding question 11 above, are you a resident living close to the proposed bypass at Lodge Lane?

- Yes No

Connection of bypass to the existing road east of Little Singleton (outlined on page 4)

13. We have decided not to progress with providing a connection of the bypass with Garstang New Road between Little Singleton and Windy Harbour junction (more information on page 4 of brochure). Do you agree with our decision based on our reasons given?

- Strongly agree Agree Neither agree or disagree
 Disagree Strongly disagree No opinion / don't know

Please explain your answer:
.....
.....

Existing roads to be bypassed (outlined on page 8 of the brochure)

17. What alterations should be made to the A585 Mains Lane and A586 Garstang Road East in Little Singleton once the bypass has been completed? (tick all that apply)?

- a. 30mph speed limit
- b. Traffic calming measures
- c. Local junction improvements
- d. Changes to traffic signal priorities
- e. Additional crossing facilities
- f. Cycle routes
- g. Alterations to street lighting

18. Is there anything else you think we should consider to improve the existing roads?

.....

.....

.....

.....

.....

19. Do you have any further comments about the A585 route?

.....

.....

.....

.....

.....

About the consultation

20. How did you find out about this consultation?

- Flyer or brochure through door
- Newspaper* website
- Poster/public notice
- Our website or email
- Newspaper* advertisement
- Local council website or email
- Newspaper* article
- Local community group

* If so, please state which paper:

21. Have you found the consultation materials useful in answering your questions?

- Yes
- To a certain extent
- No

22. Did you attend a consultation event? If so, which one?

- Singleton Village Hall
- Wyre Council offices
- Fleetwood Nautical Campus

**Thank you for taking the time to provide your opinions.
The deadline for your responses is 8 May 2018.**

Fold B



Freepost A585 WINDY HARBOUR TO SKIPPOOL SCHEME

Fold A

Folding instructions

Once you've completed the questionnaire please follow these instructions before returning it to us:

1. With the return address facing you...
2. fold the bottom part backwards along Fold A;
3. fold the top part backwards along Fold B;
4. turn the folded questionnaire over; and
5. secure it by sticking clear tape along the length of hatched area.
6. There's no need for a stamp, just pop it in the post.

1.

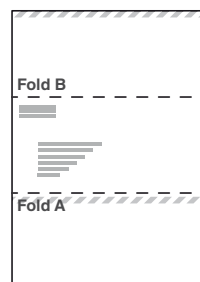

2.

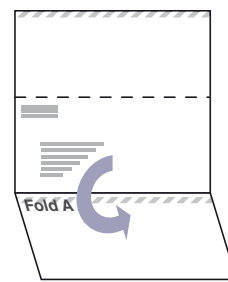

3.

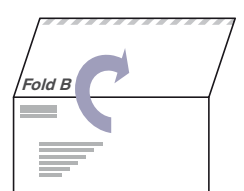

4.

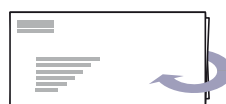

5.

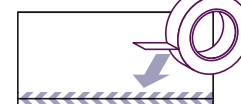

6.

