

A1

Birtley to Coal House improvement scheme Consultation questionnaire

Please tell us your views by completing this questionnaire.

Please return your completed questionnaire to us no later 23:59 on 22 March 2018.

The return address and postage is already provided so, when you have completed this form, please follow the instructions on the rear.

Please provide us with your name, address and email address. If you'd prefer for your comments to be anonymous, please just provide your postcode.

Name	<input type="text"/>
Address	<input type="text"/>
Postcode	<input type="text"/>
Email	<input type="text"/>

1. Do you agree or disagree with the proposal to improve the A1 between junction 65 Birtley and junction 67 Coal House?

Agree Disagree Neither agree nor disagree

2. Do you have any comments on our proposals to improve the A1 between Birtley and Coal House?

.....

.....

.....

.....

.....

.....

.....

Fold B



Freepost RSAS-ZGKK-CSUL
A1 Birtley to Coal House Project Team
3rd floor south
Highways England
Lateral
8 City Walk
Leeds
LS11 9AT

Fold A

Folding instructions

Once you've completed the questionnaire please follow these instructions before returning it to us:

1. With the return address facing you...
2. fold the bottom part backwards along Fold A;
3. fold the top part backwards along Fold B;
4. turn the folded questionnaire over; and
5. secure it by sticking clear tape along the length of hatched area.
6. There's no need for a stamp, just pop it in the post.

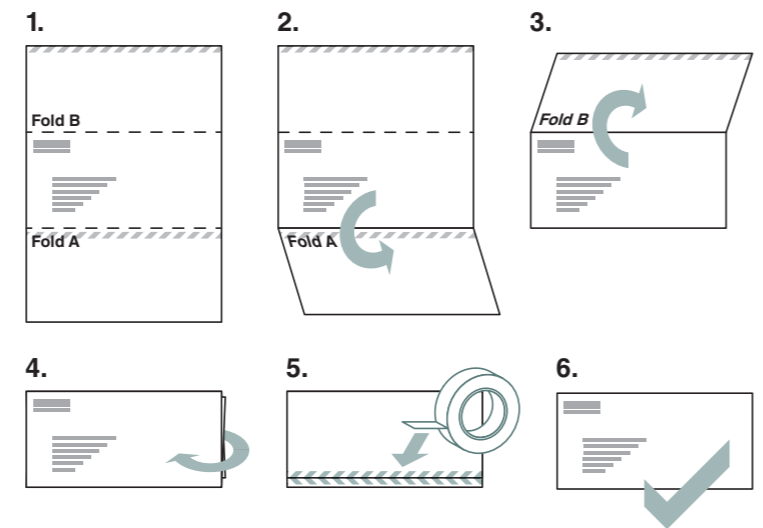

3. What else would you like to see included in the scheme and why?

.....

.....

.....

.....

.....

.....

.....

.....

.....

.....

4. Do you have any comments on the documents published with this consultation, including Preliminary Environmental Information Report, draft land and work plans?

.....

.....

.....

.....

.....

.....

.....

.....

.....

.....

5. What is your relationship to A1 Birtley to Coal House and the surrounding area?

Tick all that apply.

I live in the local area and use the A1 between junction 65 and 66 to get to/from home

I live in the local area and use the A1 between junction 66 and 67 to get to/from home

I work in the local area and use the A1 between junction 65 and 66 to get to/from work

I work in the local area and use the A1 between junction 66 and 67 to get to/from work

I use the A1 between junction 65 and 67 to get to local leisure facilities

I use the A1 but don't leave at junction 65, 66 or 67

I use the A1 between junction 65 and 67 to travel through Tyne and Wear, for example between Newcastle and Sunderland

Other (please state)

.....

.....

.....

.....

.....

.....

6. How often do you use this junction?

Daily More than once a week Weekly More than once a month

Monthly Less than once a month

7. Did you attend a consultation event?

Yes No

If so, which venue did you attend?

.....

.....

.....

8. How did you hear out about the events?

.....

.....

.....

9. We continually want to improve our communications with you. In order to help us do this, we would be really grateful if you could give us your thoughts on our communications. Your feedback will help us make things better and ensure you are getting the information you need from us, in a timely way that works for you.

.....

.....

.....

.....

.....

This section is optional but we'd be grateful if you'd tell us a little about yourself so that we understand more about the community we serve. We will not share your personal information nor will we contact you or use it for any other purpose.

10. Your gender?

Male Female Prefer not to say

11. Your age?

16 – 24 25 – 34 35 – 44 45 – 54

55 – 64 65 + Prefer not to say

12. Do you consider yourself to have a disability?

Yes No Prefer not to say